

# CLINTON SERVICE GUIDE

## MODEL 2115 FCA

### FOR

## UNIVERSAL MOUNT

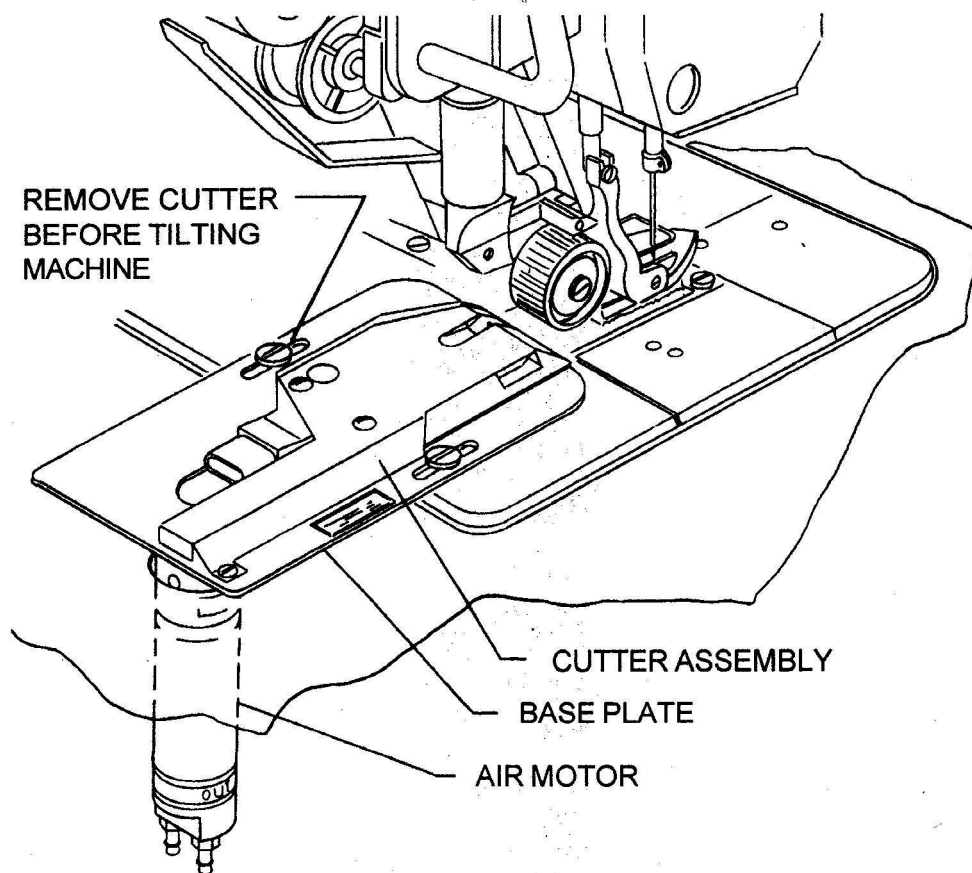

### GENERAL INFORMATION

INS-2384

- A. THE CLINTON FLAT ACTION CHAIN CUTTER, MODEL CC2115FCA, IS A CONTINUOUS CUTTING SYSTEM DRIVEN BY A MINIATURE AIR MOTOR.
- B. THE CUTTING SYSTEM ENABLES THE OPERATOR TO CUT THE CHAIN AT THE BEGINNING AND AT THE END OF THE FABRIC BEING SEWN. CUTTING ACTION IS ACCOMPLISHED AUTOMATICALLY AT THE BEGINNING CUT AND BY OPERATOR HANDLING OF THE MATERIAL AT THE END CUT.



Clinton Industries, Inc.  
700 Washington Ave.  
Carlstadt, N.J. 07072  
Phone: 201-935-4242  
Fax: 201-935-3615  
Web Site: <http://www.clintonind.com>  
Email: [general@clintonind.com](mailto:general@clintonind.com)

**VENTURI REGULATOR ASSEMBLY**  
 80-0198-02 - TABLE  
 80-0198-03 - PEDESTAL

INS-2085-1B

NOTE:  
 IN ORDER TO INCREASE VACUUM,  
 TURN THE ADJUSTING SCREW  
 COUNTERCLOCKWISE UNTIL  
 THE DESIRED AMOUNT IS REACHED.

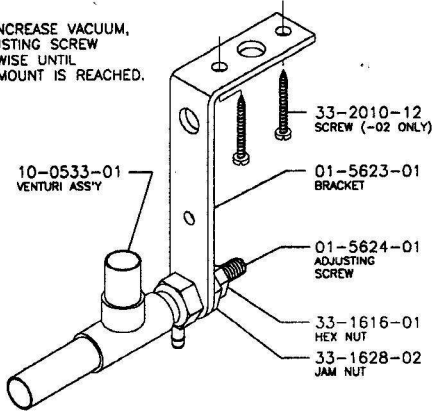

**TREADLE AIR VALVE**  
 TOE ACTION  
 80-0524-01

INS-2402A

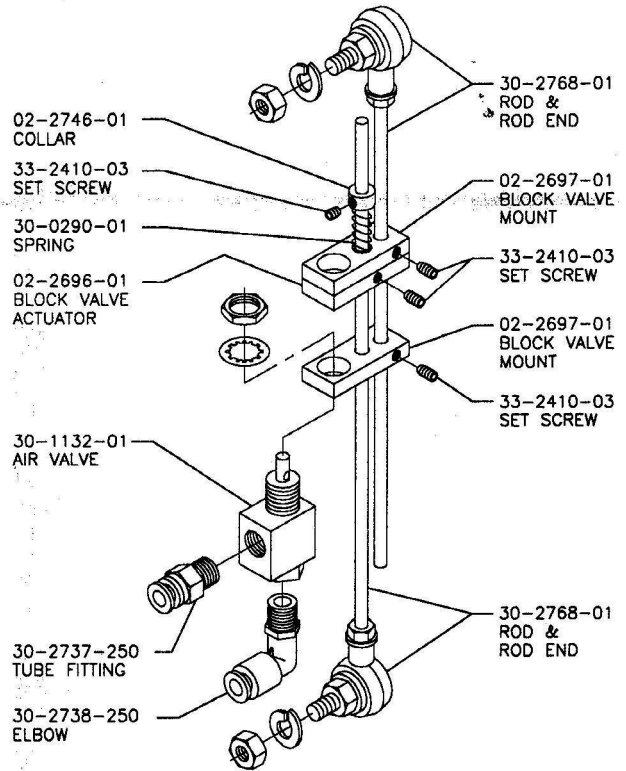

**PEDESTAL MOUNT ONLY**

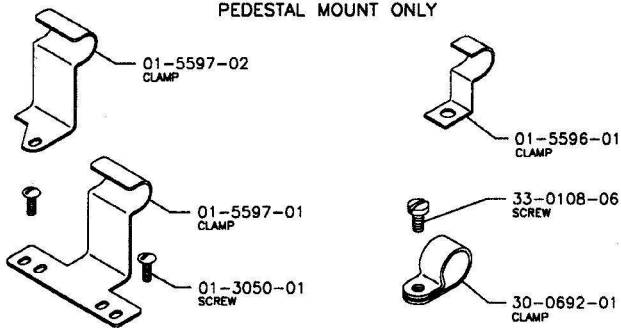

**FILTER, OILER, REGULATOR, GAUGE ASS'Y**  
 80-0415-01

INS-570-12C

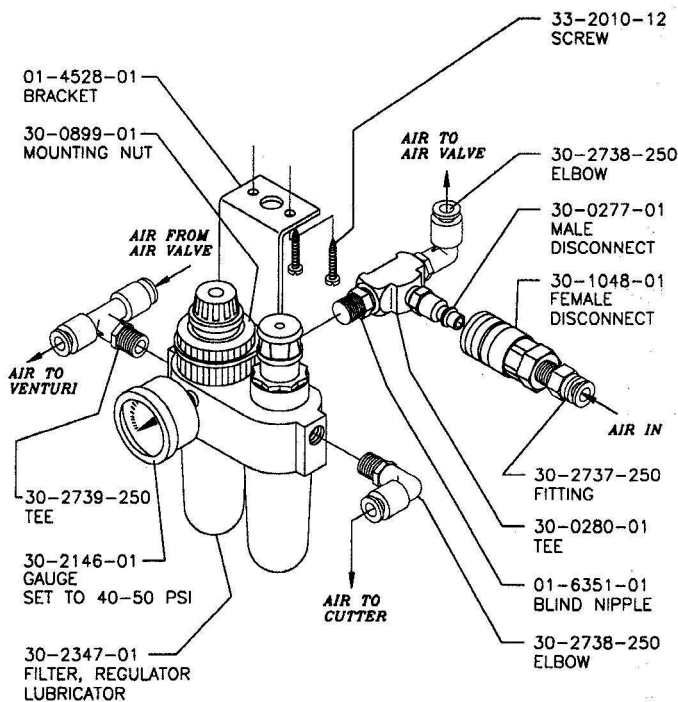

NOTE:  
 SEE INS-2100-1 AND INS-2100-2  
 FOR SPARE PARTS.

**AIR CIRCUIT**  
 80-0415-01

INS-2238A

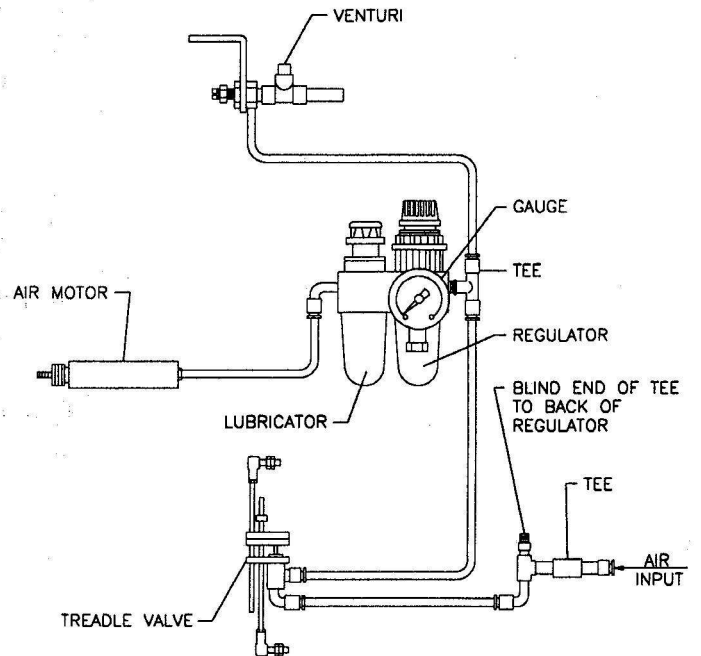

NOTE:  
 SET REGULATOR TO READ 25 PSI.  
 CUTTER WILL RUN AT APPROX.  
 2500 R.P.M.

7001

# EXTERNAL DRIVE CUTTER ASSEMBLY

MODEL 2115 FCA  
UNIVERSAL MOUNT  
80-0470-04

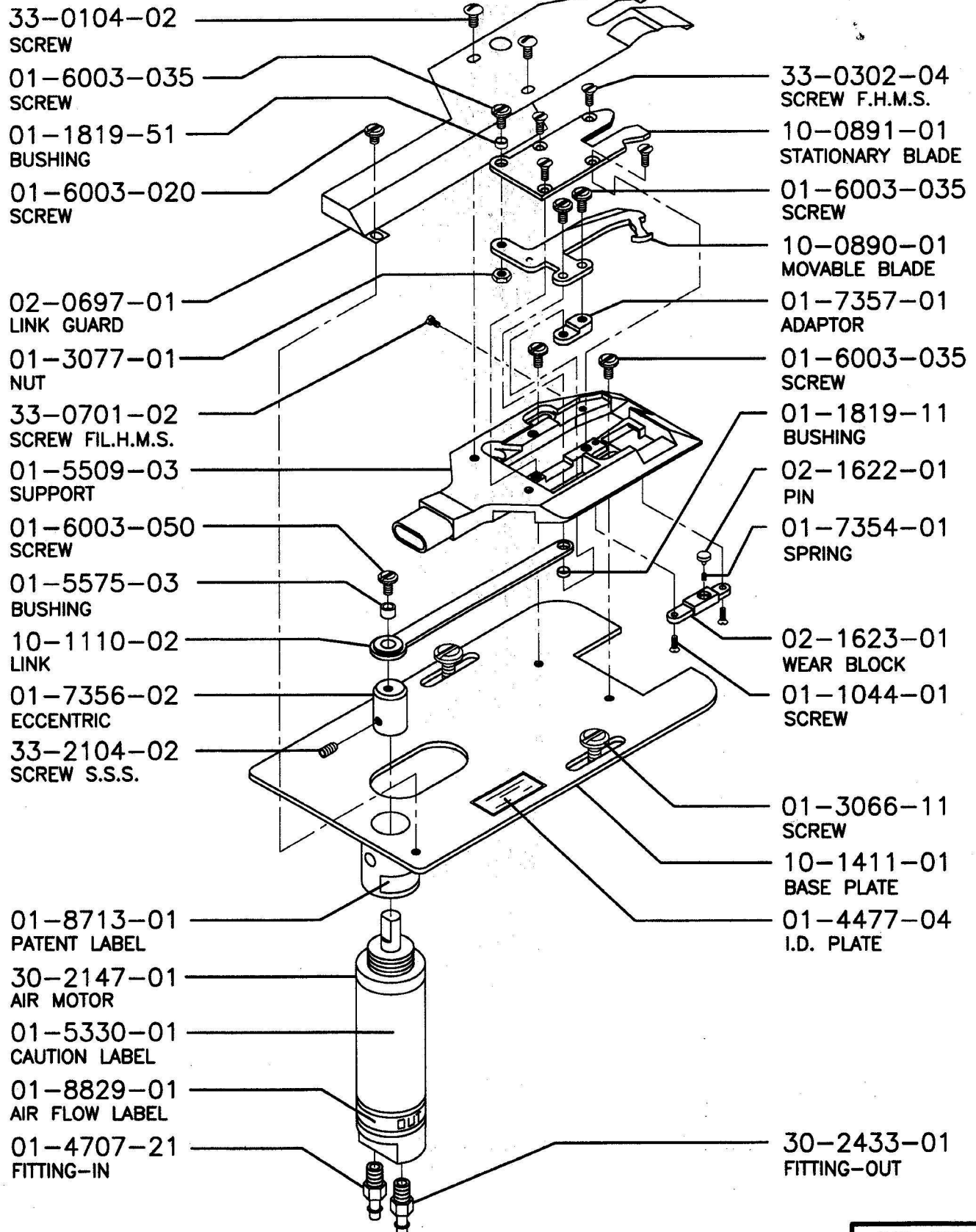

INS-2385

# AIR MOTOR MAINTENANCE

## CLEANING AND OILING OF F.O.R.G. AIR MOTOR CHAIN CUTTERS

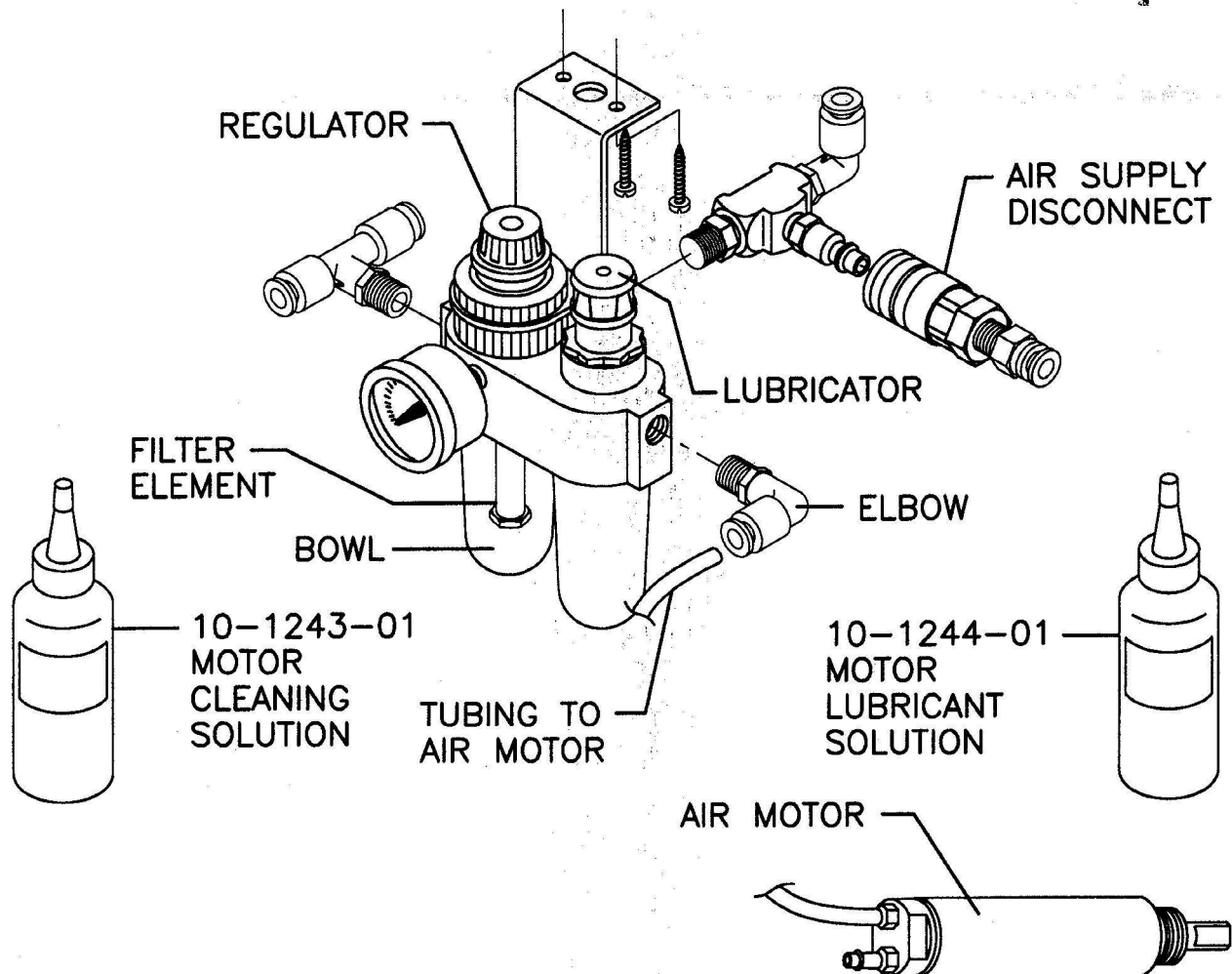

### FILTER / REGULATOR

Disconnect the air supply, remove the plastic bowl and filter element. Wash with household detergent and reassemble.

### LUBRICATOR

Disconnect the air supply, remove the bowl and wash with household detergent. Fill the bowl with lubricant 10-1244-01 and reassemble. Set the lubricator in the closed position this will produce a microfog mist to keep the motor well lubricated. Excessive oil or wrong oil will result in a sluggish operation and power loss.

### AIR MOTOR

Disconnect the air supply and the motor inlet tubing at the lubricator. Squirt some motor cleaning solution into the inlet tubing. Connect the tubing and connect the air supply and operate the motor until the solution is flushed out. Repeat this process again only this time add a few drops of lubricant instead of the cleaning solution.